



NESSC Days 2024
11 – 12 April

Kontakt der Kontinenten
Amersfoortsestraat 20
Soesterberg



NETHERLANDS EARTH SYSTEM SCIENCE CENTRE

Welcome to NESSC Days 2024!

Welcom to the NESSC Days 2024!

As usual, the NESSC Days bring together the NESSC research community in a welcoming and small-scale environment where the diverse, multidisciplinary research of NESSC can be shared, discussed and celebrated. With this being the final edition of the NESSC Days, we also will look back at the best of what NESSC has set out to do since 2014. On top of that, we are privileged to host two eminent climate scientists: prof. dr. Corinne Le Quéré and prof. dr. Eelco Rohling, whose fields of expertise exemplify the research aims of NESSC.

Our venue for the NESSC Days 2024 is conference centre Kontakt der Kontinenten in Soesterberg, situated in the Utrechtse Heuvelrug. Our main conference room will be the **Ceciliakapel**, located in a separate building on the terrain, away from the main building. Most of our activities will be in this former chapel and in the adjacent **Wintertuin Lounge**. However, dinner on the evening of April 11 and breakfast on April 12 will be served in the **KonneKt** restaurant in the main building.

The majority of our reserved accommodation can be arranged through reception in the main building. Due to present renovation activities and the limited availability of rooms at the venue, it is likely rooms become available only in the course of the afternoon, after 14:00 hours. It is therefore requested to check-in at the end of the afternoon. Luggage can be temporarily stored for free in lockers in the luggage area behind the reception desk.

Enjoy the NESSC Days 2024!

Event
Map:

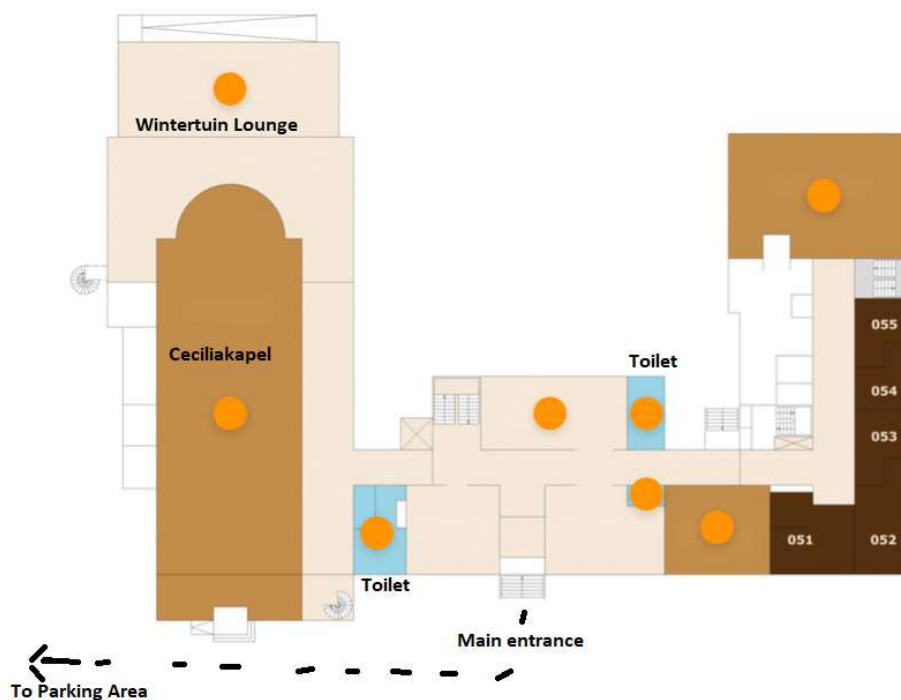

NESSC Days 2024

Programme Thursday April 11

11:30 - 12:00	Arrival / luggage storage (reception)
12:00 - 13:00	Opening lunch (Wintertuin)
13:00 - 13:15	Welcome by prof. dr. Jack Middelburg
13:15 - 14:15	Keynote by prof. dr. Corinne Le Quéré
14:15 - 14:55	Research Theme 5: Tipping points and early warning
Max Brils	<i>Climatic drivers of ice slabs and firn aquifers in Greenland</i>
Amber Boot	<i>Global marine ecosystem response to a strong AMOC weakening under low & high emissions</i>
14:55 - 15:15	Short break
15:15 - 16:15	Research Theme 4: Climate dynamics
Addison Rice	<i>Assessing temperature response in archaeal tetraether lipid distributions in marine sediments</i>
Arthur Oldeman	<i>A framework for assessing paleoclimate analogy</i>
Meike Scherrenberg	<i>The Mid Pleistocene Transition: A dance of ice, CO2 and insolation</i>
16:15 - 17:00	Research Theme 3: Ocean carbonate system dynamics
Gerrit Trapp-Müller	<i>Earth's Weathering continuum</i>
Szabina Karancz	<i>Constraining sulfur incorporation in calcite using controlled growth experiments</i>
17:00 - 18:30	Drinks (Wintertuin)
17:15 - 18:15	Social activities (archery / yoga)
19:00 - 20:30	Dinner (Restaurant KonneKt)
20:30+	Bonfire & Boardgames

NESSC Days 2024 Programme Friday April 12

- 09:00 - 09:05 Opening remarks (Ceciliakapel)
- 09:05 - 09:45 Research Theme 2: Land-ocean transfer
- | | |
|-------------|--|
| Anne Kruijt | <i>Light and temperature limitation of poleward coral reef expansion during past warm climates – a modelling study</i> |
| Yord Yedema | <i>Holocene organic carbon sequestration in the Mississippi River Delta: Comparing rates in terrestrial versus marine environments</i> |
- 09:45 - 10:45 Research Theme 1: Greenhouse gas sources and sinks
- | | |
|---------------------|---|
| Jessica Venetz | <i>The microbial methane biofilter in the water column of a brackish coastal ecosystem</i> |
| Malavika Sivan | <i>Unravelling pathway-specific bulk and clumped isotopic signatures of methane production in a marine lake sediment</i> |
| Valentin Heinzemann | <i>CO₂ fluxes under extreme drought pressure – tundra heath is more responsive than peatland in the sub-arctic</i> |
- 10:45 - 11:15 Break
- 11:15 - 12:15 Presentations NESSC Alumni
- | | |
|---------------------|---|
| Junjie Wang | <i>Changes in the global inland-water oxygen since the last century</i> |
| Michiel in 't Zandt | <i>Microbial methane cycling in a warming world</i> |
| Shruti Setty | <i>Tipping Points and Causality in the past Earth System</i> |
- 12:15 - 13:15 Lunch (Wintertuin)
- 13:15 - 13:45 NESSC Outreach & TPA Legacy
- 13:45 - 14:00 Jack Middelburg: Looking back on 10 years of NESSC
- 14:00 - 15:00 Keynote by prof. dr. Eelco Rohling
- 15:00 - 17:00 Closing remarks & social drinks
- 17:00 End